

LOCATION

Wyndham Loutraki Poseidon Resort is conveniently located on a sheltered indented coastline with crystal clear waters & magnificent view over the Corinthian Bay, just 2 km away from the famous seaside spa town of Loutraki and only 1hour from Athens. It offers the ideal starting point to explore the world renowned historical sites of Epidaurus, Mycenae, Nafplio and Ancient Corinth and significant landmarks in the region such as the monasteries in Mount Geraneia, Loutraki thermal spa center, the Heraion seaside archaeological site and Lake Vouliagmeni.

FEATURES

- 150 hectares of surrounding gardens
- 3 beaches awarded with the Blue flag
- 107 luxurious Executive & Deluxe Suites some of them with private pool or jacuzzi
- 1 Restaurant & bar (also 3 Restaurants & Bars at neighborhood Ramada Loutraki Poseidon Resort)
- 2 outdoor pools & 1 children pool*
- One indoor heated pool*
- Aegeo Spa*
- Fitness Centre*
- Mini Club for children*
- Sports & Water Sports activities*
- Private Chapel*
- Parking*
- 18-hour room service
- Express check in/ check out
- Free Wi-Fi internet connection in all public areas and rooms
- Electric club car service
- Doctor on call - 24 hours
- Transfer from and to airport
- Rent a car / excursion organizer
- Baby sitting
- Newspaper/magazine service



ROOM DETAILS

- Spacious Suites with view to the sea or gardens
- LED LCD TV 32", Satellite TV & Radio
- Independent air conditioning and heating
- Direct dial phone in room and bathroom
- Working desk
- In-room safety box (15,9 inches)
- Mini bar
- Double glazed windows
- Luxurious bathroom amenities in all suites
- Hair dryer, Bathroom scale, Bathrobes and slippers,
- Lighted magnifying mirror in the bathroom
- Dry cleaning/laundry service
- Turn down service
- Free Wi-Fi internet connection
- In room dining
- Wakeup call
- Non-smoking rooms



*shared with adjacent Ramada Loutraki Poseidon Resort

DINING AND ENTERTAINMENT

- Poseidon Restaurant next to the beach with Greek & International cuisine
- Anemos beach bar with gazebo and fountains
- Nafsika Restaurant & Bar with amazing sea view & street Mediterranean Food (open only during high season June-August)*
- Neptune Restaurant operating only during winter months*
- Amphitrión Main Restaurant with breakfast, lunch & dinner buffet *
- Pool Bar*
- Apollo Cocktail Bar*
- Dine around at Triaina Restaurant & Triaina ocean view beach bar in the neighborhood Ramada Loutraki Poseidon Resort
- Ideal location close to the most famous historic sites
- 3 beaches awarded with the Blue flag
- 2 outdoor Pools & 1 indoor heated Pool*
- Aegeo Spa with private treatment rooms, fitness area, Jacuzzi and sauna*
- Fitness Centre*
- Sports activities (table tennis, mini-football, hiking (nearby), basketball, archery, 3 tennis courts, volley ball, mini golf)*
- Water sports (ski, scuba diving, jet ski, windsurfing, sailing)*
- Mini-Club with supervised children's entertainment*

*shared with adjacent Ramada Loutraki Poseidon Resort

MEETING HIGHLIGHTS *

- 8 Halls with natural daylight and basic AV equipment with a total capacity of up to 650 pax
- Function areas for coffee breaks, cocktails and private functions
- Open Air Amphitheater by the sea with capacity up to 900 pax
- Business Centre with photocopy machine, fax, and secretarial services
- Catering and private function services
- Free Wi-Fi internet connection
- Technical support
- Independent light/sound systems
- Modern equipment rental

ATTRACTIONS

- Loutraki Thermal Spa 5 minutes
- The Corinth Canal 15 minutes
- Beautiful Lake Vouliagmeni 15 minutes
- The Ancient temple of goddess Hera 15 minutes
- The castle of Ancient Corinth 20 minutes
- The monasteries in Geraneia mountain 15 minutes
- The ancient palace of King Agamemnon in Mycenae 1 hour
- The famous ancient theatre of Epidaurus 1 hour
- The historic town of Nafplio 1.30 hours
- The ancient oracle of Delphi 2.50 hours
- Islands of Aegina and Aggistri: Whole day cruise-private boat can be chartered.
- Nemea vineyards - wine tasting can be organized

GETTING THERE



- 15 minutes from National highway
- 5 minutes from Loutraki
- 1 hour drive from Athens and the International El.Venizelos Airport through the National highway
- 1 hour by train from Athens and the El.Venizelos International Airport.
- 1 hour and 15 minutes from Piraeus port

*shared with neighborhood Ramada Loutraki Poseidon Resort

MEETING SPACE CAPACITY CHART

	THEATRE	CLASSROOM	BANQUET	COCKTAIL	U-SHAPE
APOLLO LOBBY	420	200	400	500	70
APOLLO 1	100	60	100	100	35
APOLLO 2	40	30	60	60	21
APOLLO 3	190	130	150	150	-
APOLLO 4	80	50	70	70	-
EXECUTIVE BOARDROOM	-	-	-	-	14
ARTEMIS 1	40	30	30	50	21
ARTEMIS 2	40	30	30	50	21
OPEN APHITHEATRE	900	-	-	-	-
AMPHITRION RESTAURANT	-	-	650	-	-
TRIAINA RESTAURANT	-	-	120	-	-
NAFSIKA BAR RESTAURANT	-	-	120	-	-
POOL BAR	-	-	90	-	-
POSEIDON RESTAURANT	-	-	140	-	-
NEPTUNE	-	-	120	-	-



FLOOR PLANS CHART

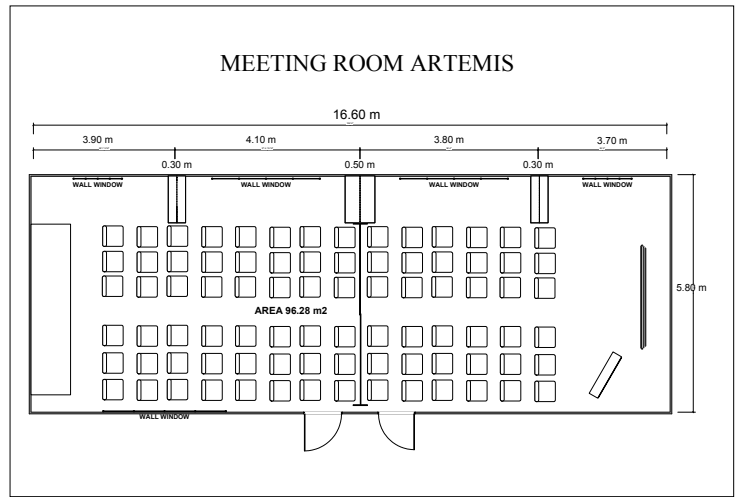
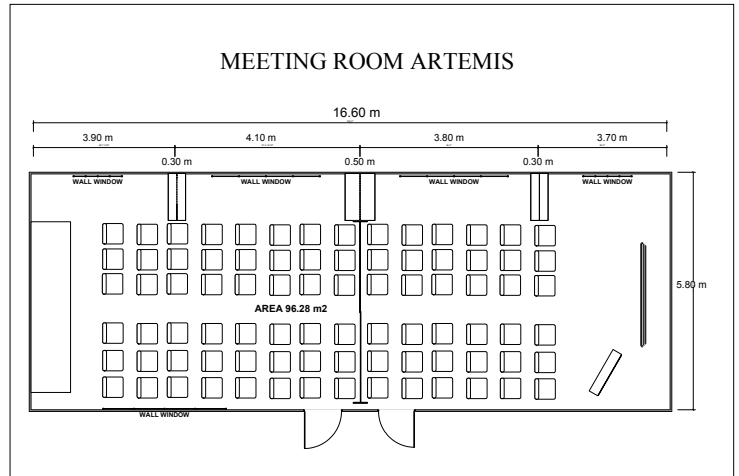
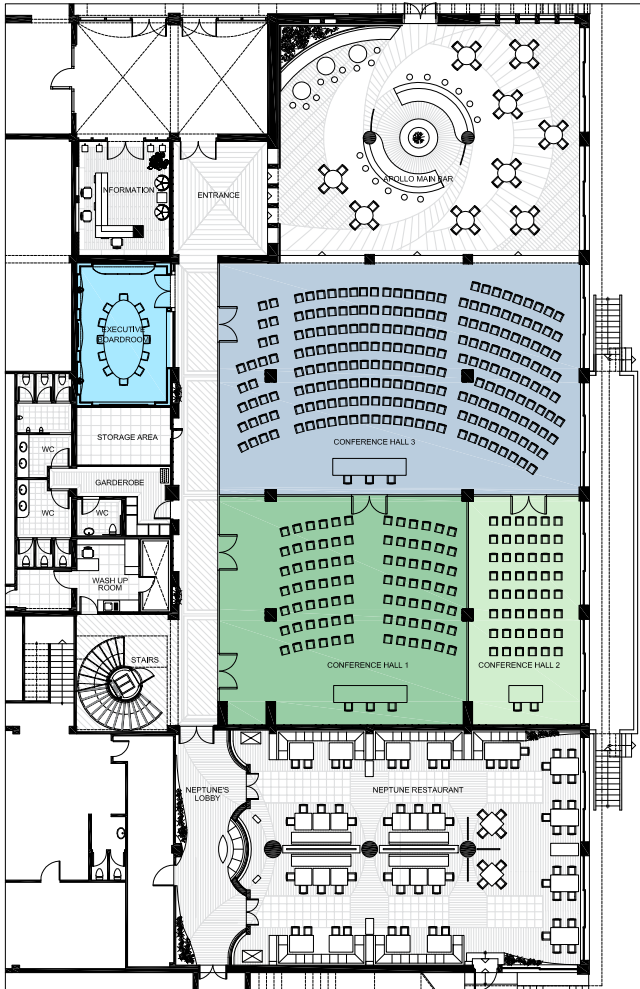

FOR FURTHER INFORMATION OR RESERVATIONS PLEASE CONTACT:
 Wyndham Loutraki Poseidon Resort
 Loutraki Korinthias Greece, GR 20300
 Tel: +30 27440 67938
 e-mail: reservations@wyndhamloutrakiresort.com

WWW.WYNDHAMLOUTRAKIRESORT.COM

Managed by **ZEUS INTERNATIONAL**